

Street Banner Pole-Mounted

Assembly Instructions | R1.112019

ASSEMBLY HARDWARE

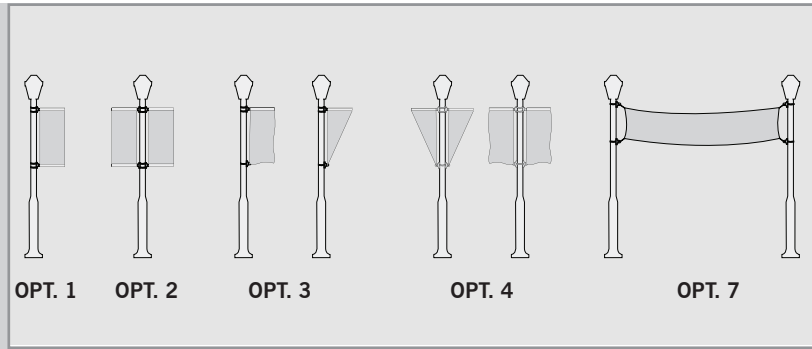
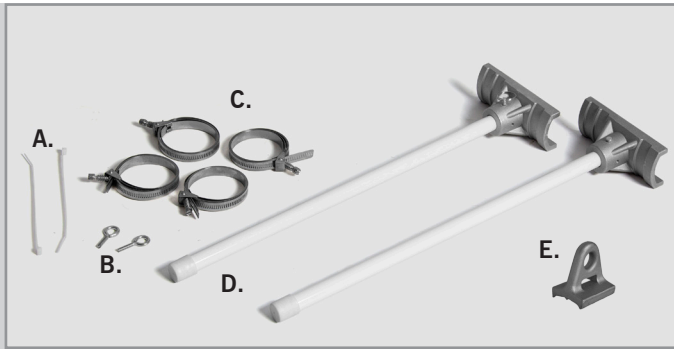

- A. Zip ties
- B. Eyelet screws
- C. Stainless steel bands
- D. Fiberglass poles & mounting brackets
- E. Eyelet bracket (Options 3, 4, and 7 only)

POLE & BRACKET ASSEMBLY



NOTE: Divide the number of steel bands by the number of brackets to determine how many steel bands are needed per bracket.

1. Determine the height of the top mounting bracket. Wrap the steel bands around the pole, and feed the end of the steel band through the tension buckle while the hex screw is in the "open" position.
2. Place the mounting bracket between the steel bands and the pole. **Make sure the eyelet screw hole on the bracket is facing in towards the banner.** Pull the steel bands tight and push the screw to the "closed" position. Tighten the screw with a drill or screwdriver to secure it to the pole. Repeat for the other steel bands.
3. Once the mounting bracket is secured to the pole, insert the eyelet screw into the bracket and screw it into place. This will stabilize the fiberglass pole.
4. Slide the banner's top pole sleeve onto the pole and secure with a zip tie.
5. Determine the placement of the bottom mounting bracket by pulling the banner down until it is taut. Slide the bottom pole into the banner's bottom pole sleeve and set the bottom bracket into place. Repeat steps 1 - 3 to secure the bottom bracket.
6. Once the bottom bracket is assembled, secure the banner with a zip tie.



DISCLAIMER: Wind tests demonstrated our street banners can withstand wind gusts up to 55-63mph (10bft). Maximum recommended and guaranteed size for street banners produced by us and used with our hardware is 24 sqft (30sqft for Option 7 and 8). Stainless steel bands are designed to be used on round poles only. User must read and observe assembly instructions. If this is not done correctly it may result in damage to the unit, injury, or death, and all warranties will be void. All warranties will be void if the street banner hardware is used with any flag not produced by us.



Street Banner Plus Pole-Mounted

Assembly Instructions | R1.062019

EYELET BRACKET ASSEMBLY

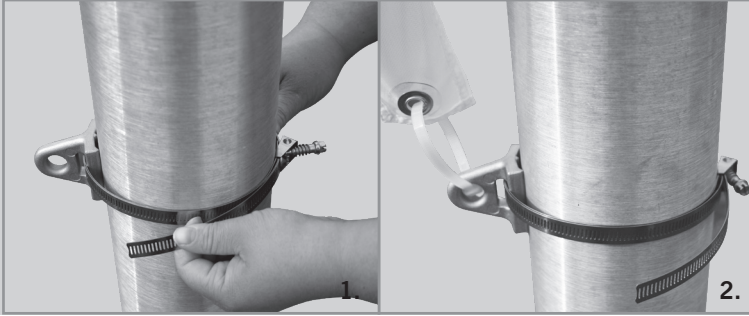

1. Determine the position of the eyelet bracket(s). Wrap a steel band around the pole and thread it through the bracket while the hex screw is in the “open” position. Feed the end of the steel band through the tension buckle, then pull the steel band tight and push the screw to the “closed” position. Tighten the screw with a drill or screwdriver to secure it to the pole.

2. Once the bracket is assembled, secure the banner by attaching the zip tie to the banner’s grommet and the bracket.



Wind tests demonstrated our Street Banners can withstand wind gusts up to 55-63mph (10bft). Maximum recommended and guaranteed size for the Street Banner Plus produced by us and used with our hardware is 24 sqft (30sqft for Option 7 and 8). Stainless Steel Bands are designed to be used on round poles only. User must read and observe assembly instructions. If this is not done correctly it may result in damage to the unit, injury, or death, and all warranties will be void. All warranties will be void if the street banner hardware is used with any flag not produced by us.



Street Banner Wall-Mounted

Assembly Instructions | R1.112019

ASSEMBLY HARDWARE

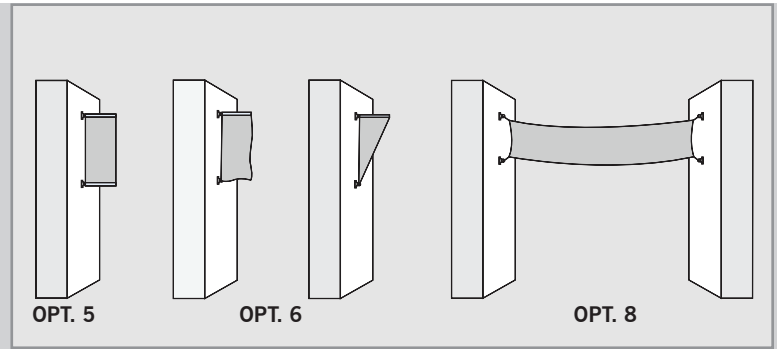
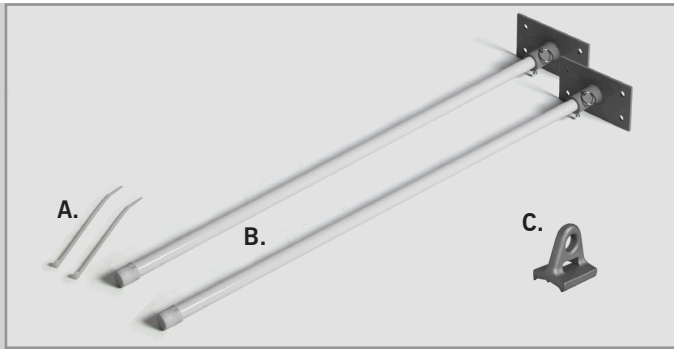

- A. Zip ties
- B. Fiberglass poles & mounting brackets
- C. Eyelet bracket (Options 6 & 8 only)

POLE & BRACKET ASSEMBLY

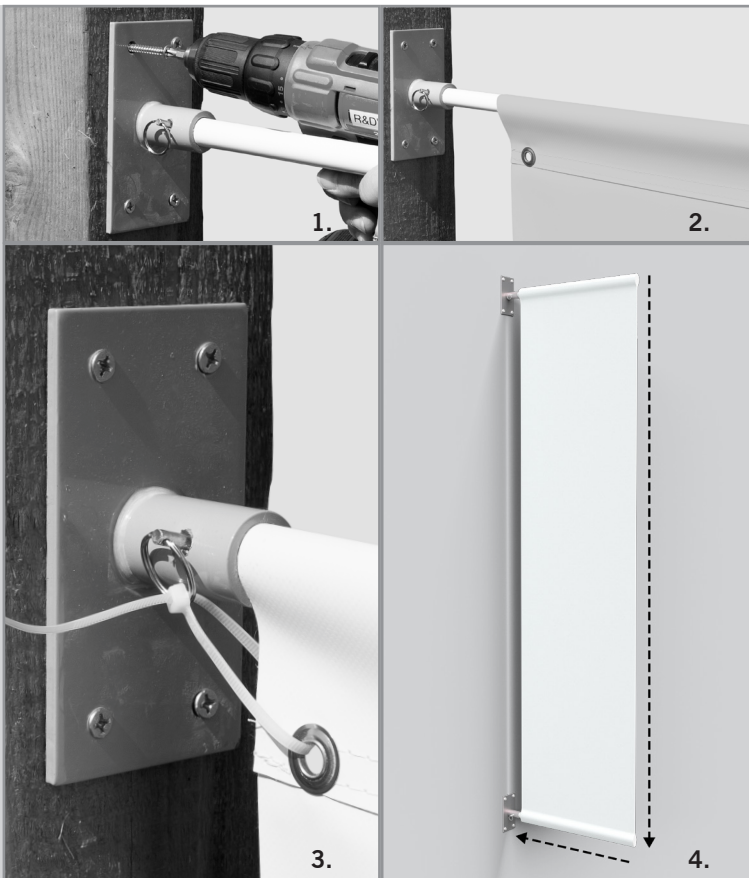

1. Determine the height of the top mounting bracket and drill the bracket into place (screws not included).
2. Slide the banner's top pole sleeve onto the pole.
3. Secure the banner by attaching a zip tie to the banner's grommet and the bracket's pin ring.
4. Determine the placement of the bottom mounting bracket by pulling the banner down until it is taut. Slide the bottom pole into the banner's bottom pole sleeve and drill the bottom bracket into place. Secure the banner with a zip tie.

EYELET BRACKET ASSEMBLY

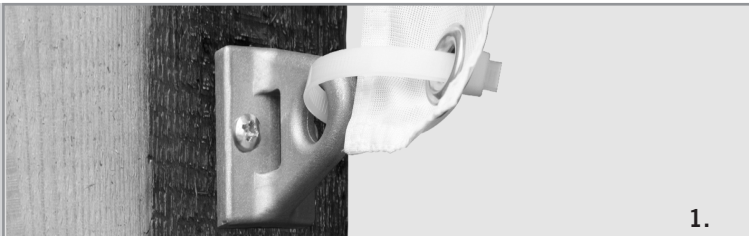

1. Determine the placement of the eyelet bracket(s) and drill the bracket(s) into place (screws not included). Once installed, secure the banner by attaching the zip tie to the banner's grommet and the bracket.



DISCLAIMER: Wind tests demonstrated our street banners can withstand wind gusts up to 55-63mph (10bft). Maximum recommended and guaranteed size for street banners produced by us and used with our hardware is 24 sqft (30sqft for Option 7 and 8). User must read and observe assembly instructions. If this is not done correctly it may result in damage to the unit, injury, or death, and all warranties will be void. All warranties will be void if the street banner hardware is used with any flag not produced by us.

