

## ASSEMBLY HARDWARE

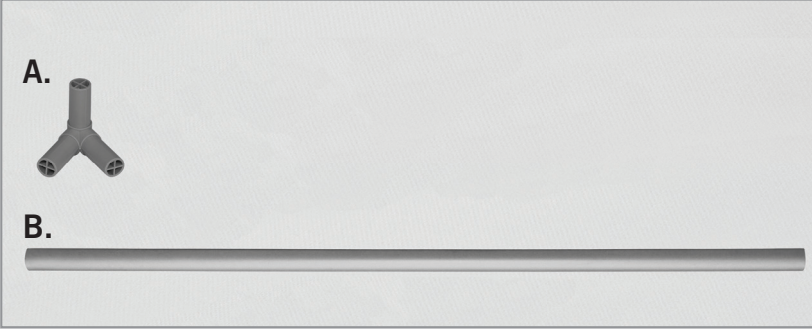

A. 60° Connector(s)  
B. Aluminum Pole(s)

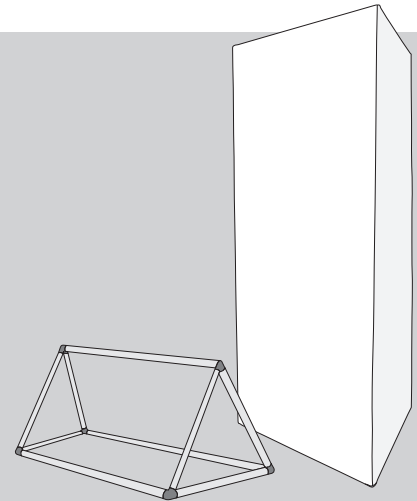

## ASSEMBLY

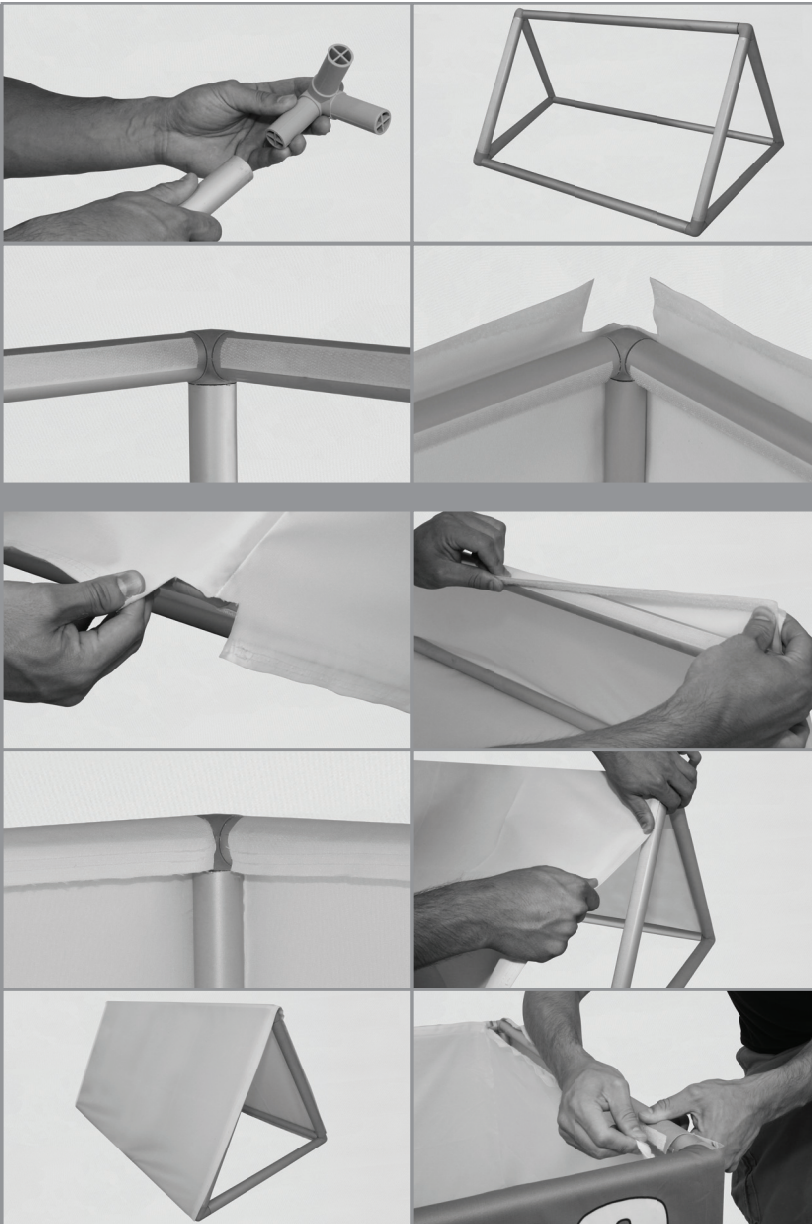

1. Assemble the Aluminum poles (B) and 60° connectors (A) to create the Triangle 3D or Floor Tent display.

- If the print is a closed top or single-reverse, then assemble Aluminum poles (B) with the hook-and-loop adhesive so they will line up with the print. The hook-and-loop adhesive on the Aluminum poles (A) should also be angled inward slightly to make the print taut.

2. Attach print depending on layout option:

- **Triangle 3D with closed top & Floor Tent with closed sides** – Slip print over the top of frame and pull taut. Wrap the tabs on the bottom of the print under the bottom of the frame and attach to the hook-and-loop adhesive.
- **Single-reverse: Triangle 3D** – Slip print over the top of the frame. Wrap tabs on the top of the print over the top of the frame and attach to the hook-and-loop adhesive. Pull print taut and wrap the bottom tabs under the frame and attach to the hook-and-loop adhesive.
- **Single-reverse: Floor Tent open sides** – Position the top of the print so it is centered over the top of the frame. Attach the hook-and-loop adhesive along the sides from top to bottom. Wrap the tabs on the bottom of the print under the bottom of the frame and attach to the hook-and-loop adhesive.
- **Double-sided: Triangle 3D only** – Flip frame upside down and slip the print on. Flip frame and print over and pull the print upwards. Wrap the outside of the print over the frame and attach to the inside of the print using the hook-and-loop adhesive.