

Cross Base C

R1.080910



Cross Base C
with Thorn
includes:



Cross Base C
with Spring Thorn
includes:

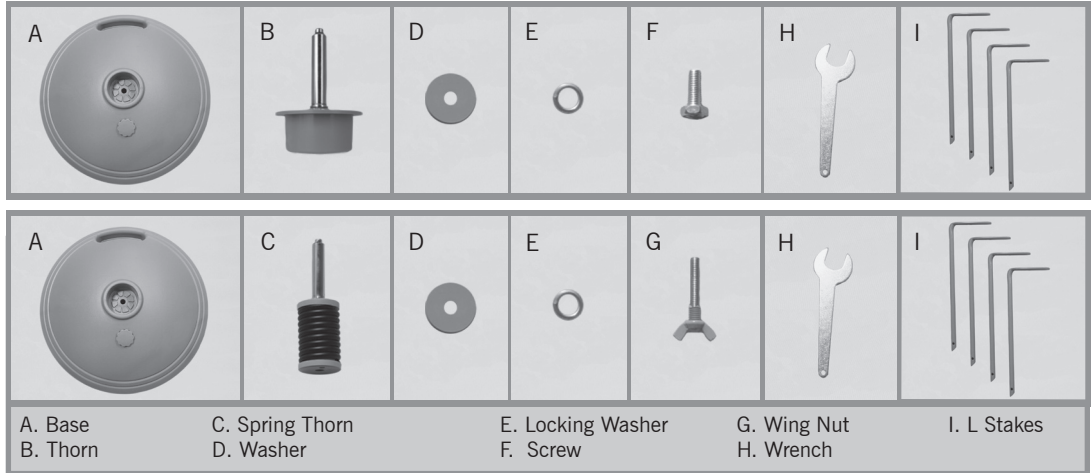

1

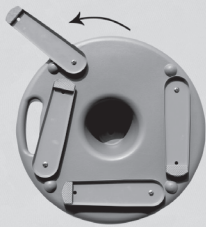

1. Turn the base (A) upside down and slide all legs into the extended position.

2

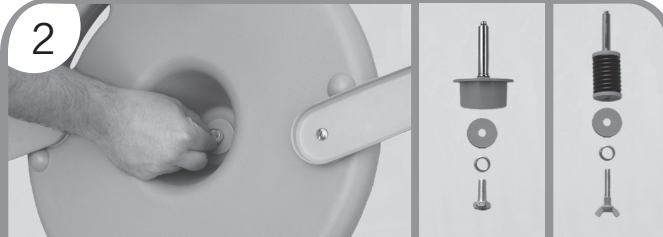

2. Holding the base (A), place the large gray part of the thorn (B) into the opening on top of the base (A). While holding the thorn (B) in place, hold the base on its side for access to the underside. Place the locking washer (E) followed by the washer (D) onto the screw (F). Insert into the opening on the base (A) to secure the thorn (B). *For the spring thorn (C), follow step two for the thorn (B) and replace the screw (F) with the wing nut (G).

3

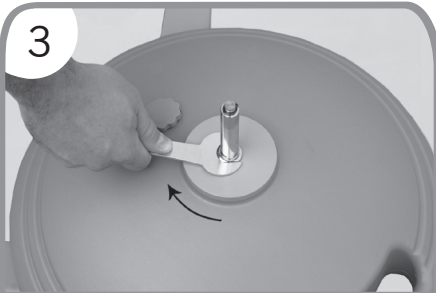

3. Use the included wrench (H) to tighten the thorn (B) from the top of the base (A).

4



4. To fill with water, locate the cap on top of the base (A) and remove. Use a hose for easy filling. Replace cap and tighten when finished. To secure the base in ground, push L Stakes (I) through the provided holes on the legs of the base.

