

COUNTER MAGNET

Assembly Instructions | R1.101117

ASSEMBLY HARDWARE

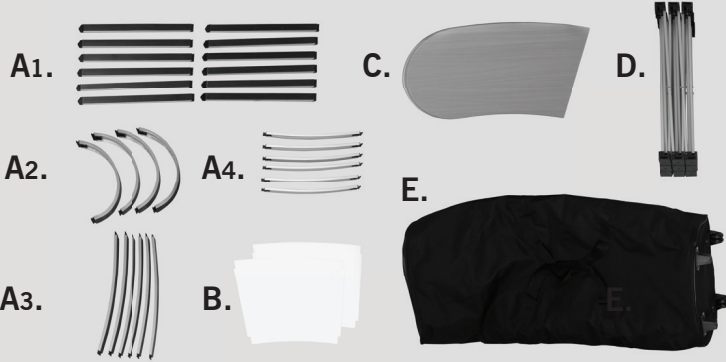

- A. Metal frame bars
 - A1. Straight, magnetic
 - A2. Semi-circular, magnetic
 - A3. Curved, magnetic
 - A4. Curved, non-magnetic
- B. Shelves
- C. Wooden tabletop
- D. Aluminum frame
- E. Polyester carrying case

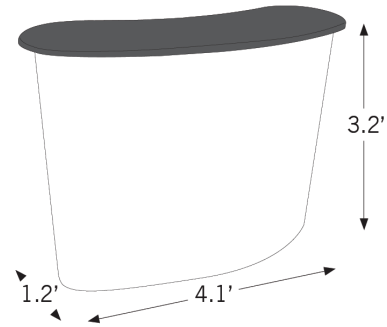

ASSEMBLY

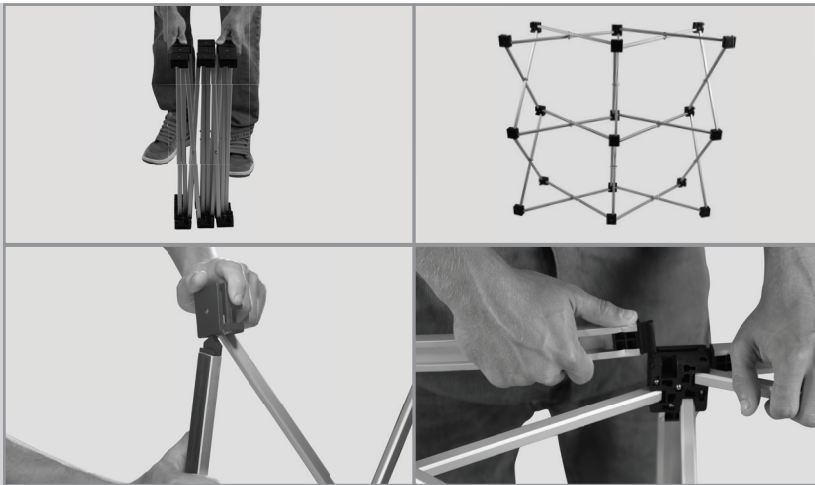

1. Expand aluminum frame (D) three-quarters (3/4) of the way open.
2. Attach six of the straight, magnetic metal frame bars (A1) vertically to the front of the frame. The front is the side of the frame with the wider curve. Attach the other six to back of the frame. Ensure that the magnetic strips on the metal frame bars are facing outward in each case.
3. Attach six of the curved, magnetic metal frame bars (A3) horizontally to the front of the frame. Two metal frame bars should be attached to the top, two to the middle, and two to the bottom. Ensure that the magnetic strips on the metal frame bars are facing outward.

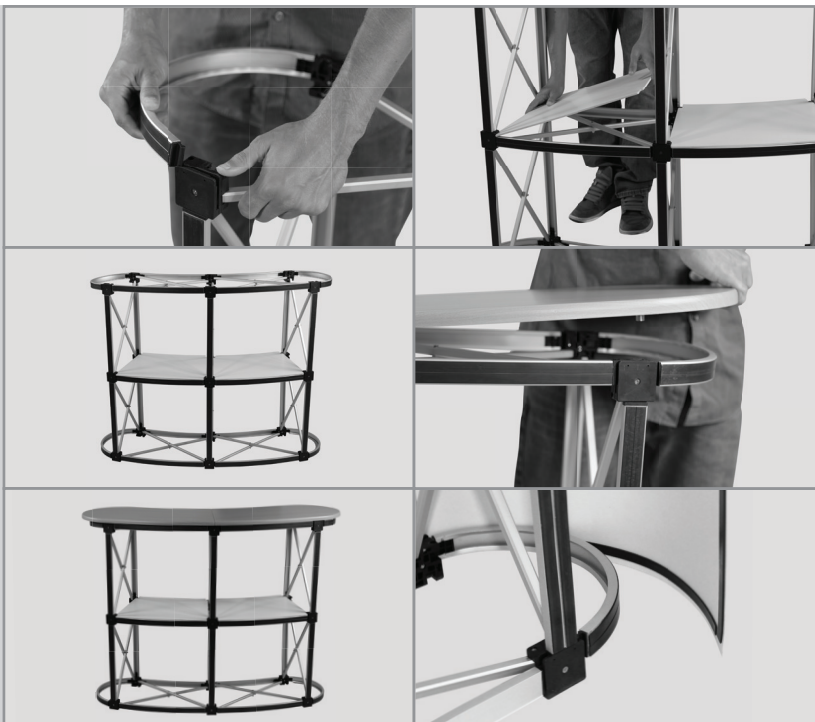

4. Attach six of the curved, non-magnetic metal frame bars (A4) horizontally to the back of the frame. Two metal frame bars should be attached to the top, two to the middle, and two to the bottom. Ensure that the flat sections of the non-magnetic metal frame bars are facing outward.
5. Attach four of the semi-circular magnetic metal frame bars (A2) to the outside edges of the frame. Two of the metal frame bars should be attached to the top outside edges and two should be attached to the bottom outside edges. Ensure that the magnetic strips on the magnetic metal frame bars are facing outward in each case.
6. Sit the white shelf sections (B) in the middle section of the frame. Ensure that the cutouts in the shelf sections match up with the frame protrusions and that the wider edge of the shelf section is facing the front of the frame.
7. Lay the wooden tabletop (C) on top of the frame. To secure the tabletop, guide the pegs on the bottom of the tabletop into the peg holes at the top of the frame.
8. Attach your print to the counter using the magnetic strips of the metal frame bars.