

Arched Display

R2.091814

ASSEMBLY HARDWARE

A. Support Feet



B. Bottom/Top Corners



C. Frame Poles



D. Carrying Case

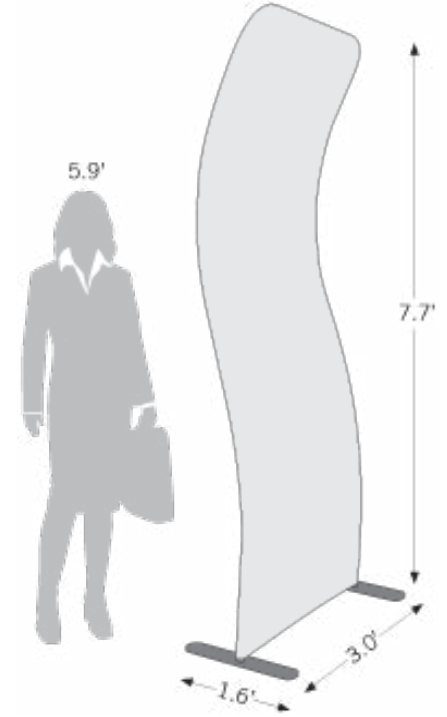

ASSEMBLY

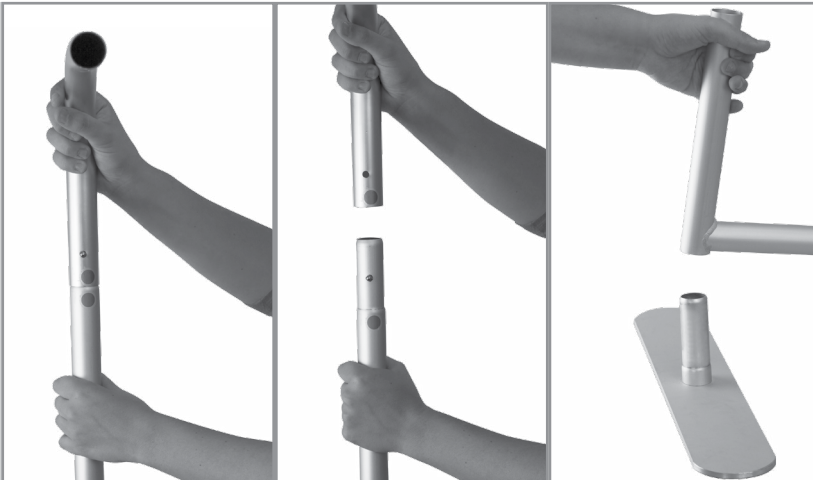

1. Remove from the carrying case all aluminum frame pieces and set them approximate to where you plan on placing the display. Leave the print in the bag for the time being so the print does not become dirty.
2. Each piece of the aluminum frame will have sticker(s) with a shape on them to indicate the connections. Pieces with the same shapes should be connected together.
3. The frame connects using click button assembly. Place the piece with the button into the hole of the piece you want to connect. Press the button down and release when it slides into the hole. Push the piece with the hole down until the button clicks into place.
4. Repeat the steps above for all of the main frame (B and C) pieces.

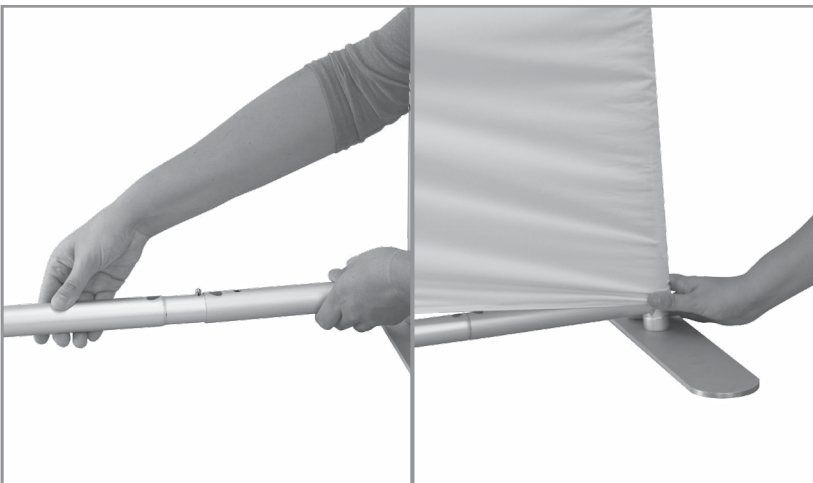

5. Connect the frame to the support feet (A) by placing the bottom ends into the feet.
6. The print (D) covers the frame from the top down. You may want to seek help from another person for this part. Slide the open end over the frame until it stretches down to the support feet.
7. When disassembling, if you are unable to entirely push the button, push down the connected piece a little bit and try again.